

UTM[®] - WITH C-STIC

INSTALLATION AND MOUNTING GUIDE

SCCSTICKIT

01 COMPONENTS



C-Stic



SC-621396_01

Single, 1m UTM Cable with Rotarex C-Stic Connector



UTM[®]

IMPORTANT: THE ASSET MUST BE CREATED IN TRANSCEND WEB PORTAL PRIOR TO THE INSTALLATION.

02 INSTALLATION



STEP 1

Slide out the cap at the top of the C-Stic to expose the connection. The connection is keyed. Make sure to connect the UTM cable to the C-Stic in the correct position.

IMPORTANT #1: If needed to disconnect the C-Stic from the UTM cable, use a screwdriver to push down on the locking pin and push up to be able to remove it.

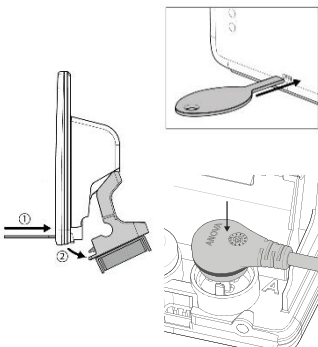

STEP 2

WARNING: It's critical the C-Stic sensor is already mounted in place before proceeding.

Connect the UTM[®] to the C-Stic sensor:

- 1 - Detach bracket.
- 2 - If using only 1 sensor, install into PORT A on the rear of the UTM.
- 3 - Press down firmly on the ZAB plug until the O-Ring is sealed. It may require you to press down with 2 thumbs. **The UTM[®] will begin to activate automatically.**

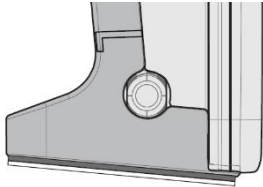

STEP 3 – VELCRO ADHESIVE MOUNTING (OPTIONAL)

The UTM® Bracket will have at the bottom a Velcro mount with an adhesive surface to secure/mount the UTM® next to the tank. The UTM® should be mounted on a surface near the tank.

It's not recommended to mount the UTM® directly on the Tank's surface with the Velcro adhesive.



Select the surface's location where the UTM® will be mounted and clean that area thoroughly to ensure it is free from any greasiness/dirt and completely dry.

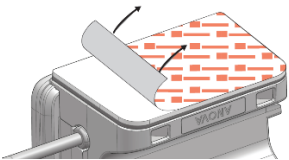

Peel backing off from the Velcro adhesive and place the unit on the selected surface. Fix the UTM® in place by pressing down firmly so the adhesive properly attaches to the desired surface.

IMPORTANT #2: For the adhesives to **SUCCESSFULLY ATTACH** to the surface, the **TANK SURFACE TEMPERATURE** must be **ABOVE 60°F/15°C** and a **CURING TIME** of **MINIMUM 24 HOURS** is needed.

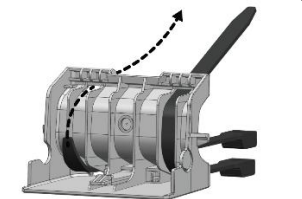

STEP 3 – ZIP TIES MOUNTING (OPTIONAL)

Insert the zip ties on the back bracket of the UTM® to be able to secure it to the tank.

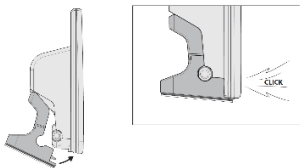

Attach the bracket to the back of the UTM®.

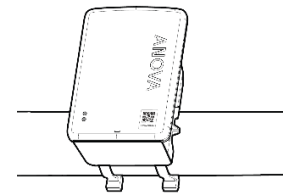

The UTM® should be mounted vertically on the top ring of the Micro Bulk Tank.



STEP 4 (OPTIONAL)

If manual activation is required:

- 1 – Activate UTM by holding the activation wand in place for 6 seconds.
- 2 – LEDs will begin to flash.
- 3 – Watch for solid green to confirm successful communication.

IMPORTANT #3: If the activation attempt failed (solid red light at the end of the attempt), wait at least 2 minutes before trying to activate the UTM device again.

ANOVA SUPPORT

HOURS: MONDAY-FRIDAY 7AM TO 5PM (CENTRAL TIME)

IG DIVISION:

+18666268425 | support@anova.com