



ANOVA

Connecting the industrial world - for better.

ANOVA

FIELD

FIELD APP NEW INSTALL GUIDE

ABSTRACT:

This document provides users a quick guide on how to do an install using Field App for Industrial Gases and Chemicals.

ANOVA SUPPORT

North America: 1-866-626-8425	(7:00 AM – 6:00 PM EST)
Europe: +44-1536-264-777	(8:00 – 17:00 GMT)
Germany: +49-(0)631-205-777-22	(9:30 – 17:30 GMT)
Asia: +60-3-6207-1659	(16:00 – 24:00 GMT)

EMAIL:
support@anova.com

1.

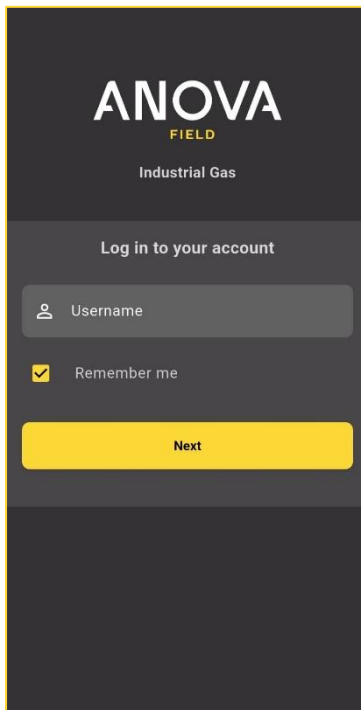

1. Log in with your email and password.

2. Tap **“New installation.”**

2.

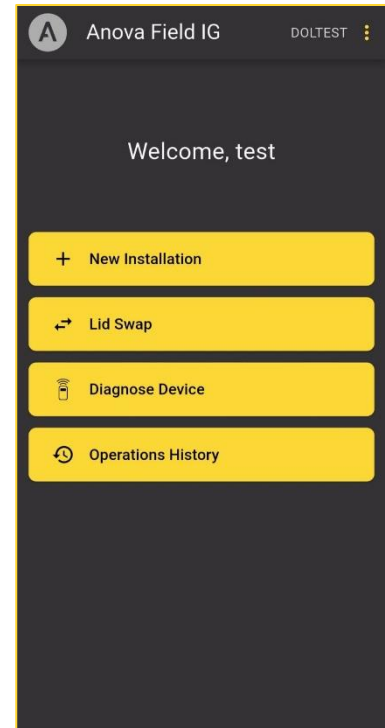

3.

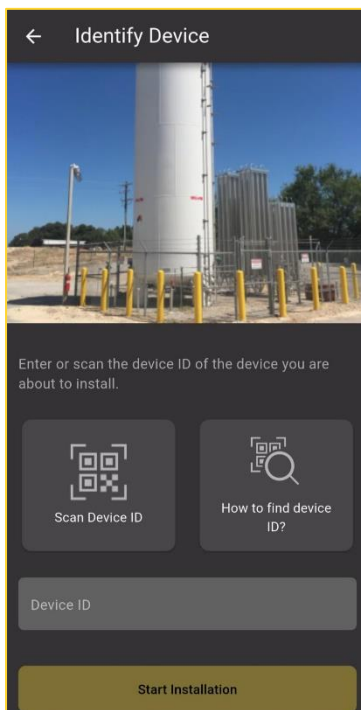

3. You will be prompted to identify your device. You can either **scan the QR code** or **manually enter the device ID**. Then, tap **“Start Installation”**.

4. On the next screen, the app will ask if you would like to view **technical diagrams**. Select **“Yes”** or **“No”** based on your preference to proceed.

4.

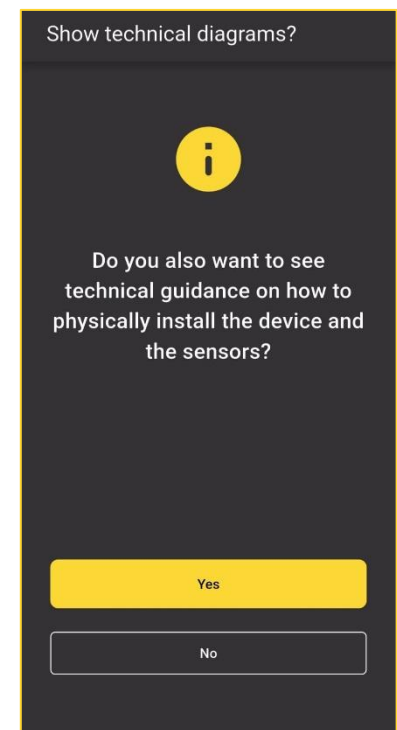

5.

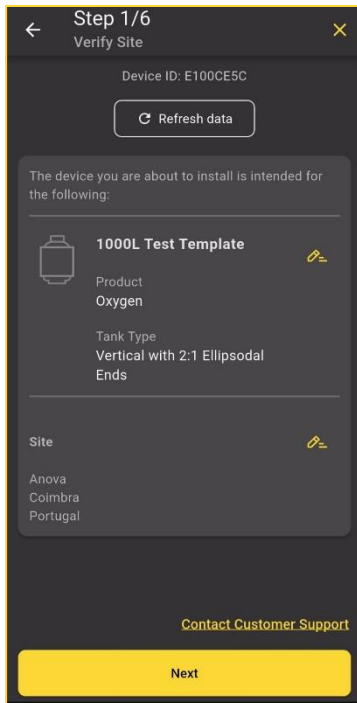

5. You will then see the **templates of similar tanks**. Select the one that it's correct. If needed, tap the **yellow pencil icon** on the right to edit the configuration. If the template is correct, tap **"Next"**.

6. Verify that **all connections are properly made**, and that the **sensor is connected to the correct ports**.

6.

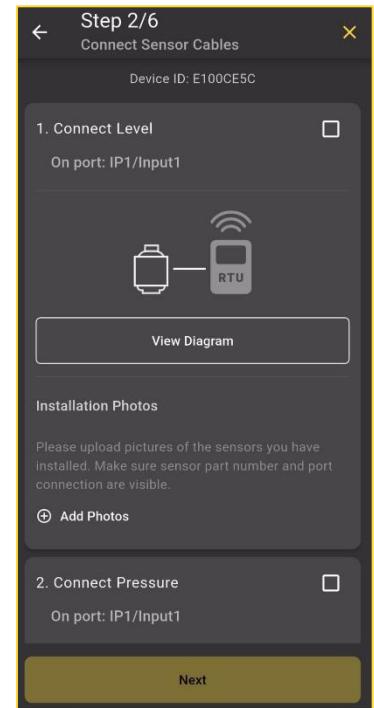

7.

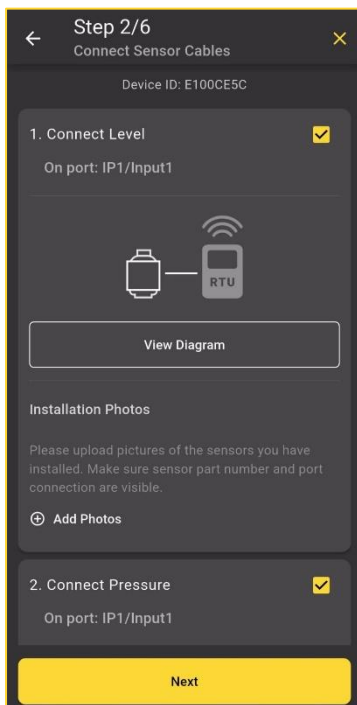

7. After confirming the connections, make sure the **option box is selected**—it should display a yellow highlight on the right side of the channel. You may also **add photos of the sensor connections** to supplement the installation. Once complete, tap **"Next"**.

8. Ensure the **battery is connected**, then tap the confirmation box in the top right corner, just like on the previous screen. After verifying, tap **"Next"**.

8.

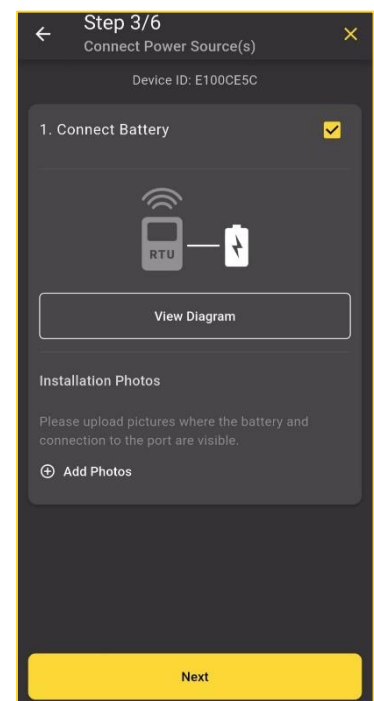

9.



9. Confirm that the **scale settings match the connected sensors**. You can edit the information by tapping the **yellow pencil icon**. Once verified, tap **"Next"**.

10. Perform a **test packet** on the unit as guided by the app. When the test is complete, check the **"Completed"** box and tap **"Next"**.

10.

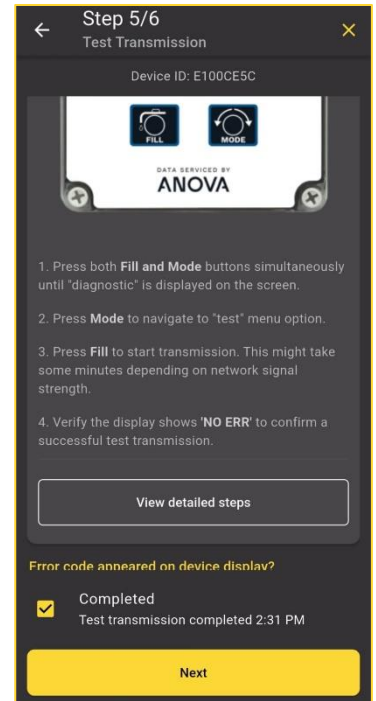

11.

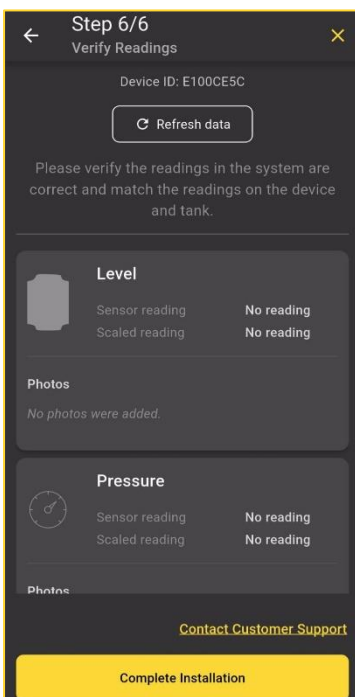

11. The final screen will display your **readings**. If everything appears correct, tap **"Complete Installation"**.

12. Installation is complete! You should see the message **"Device successfully installed"** on your screen. Tap **"Done"** to return to the main menu.

And that's how to complete a quick installation using the Field IG App.

12.

