

Start

1

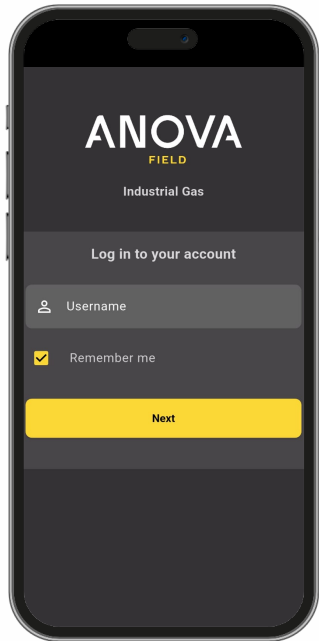

Open the Field IG App and log in with your email and password.

Search

2

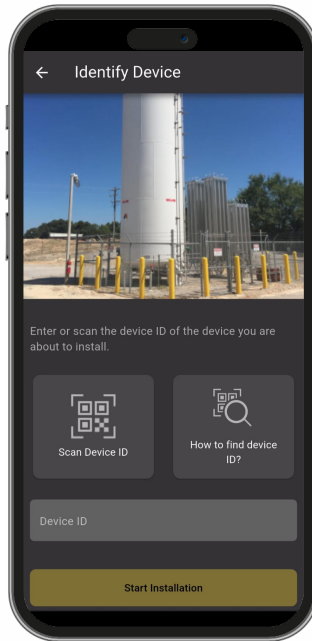

Tap "New Install", enter the ID Number. Then tap "Start Installation".

Select

3

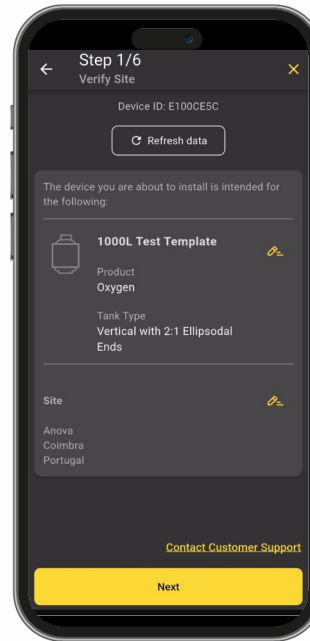

You'll see templates of similar tanks. Select the correct one. To edit, tap the yellow pencil icon. If it's correct, tap "Next."

Confirm

4



Check that all connections are correct and the sensor is in the right ports. Make sure the option box is selected—it will show a yellow highlight on the right. You can also add photos of the sensor connections. When ready, tap "Next."

Test

5

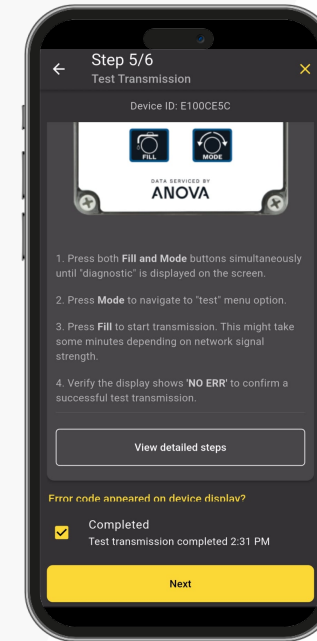

Make sure the scale settings match the connected sensors. To edit, tap the yellow pencil icon. Once confirmed, tap "Next." Follow the app to run a test packet. When it's done, check the "Completed" box and tap "Next."

Finish

6

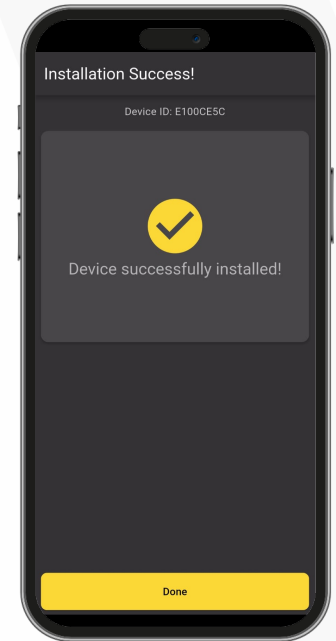

You'll see "Device successfully installed!" and when done, press the "Done" button.

